

CABINET FOLDING SLIDING DOOR SYSTEM

Folding door catalogue

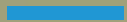

“Max door open for cabinet ”

Different folding; different movement; different assembly,
CEMUX combine the technique and customer needs to our
folding sliding door system series.



Folding sliding system

SWF002

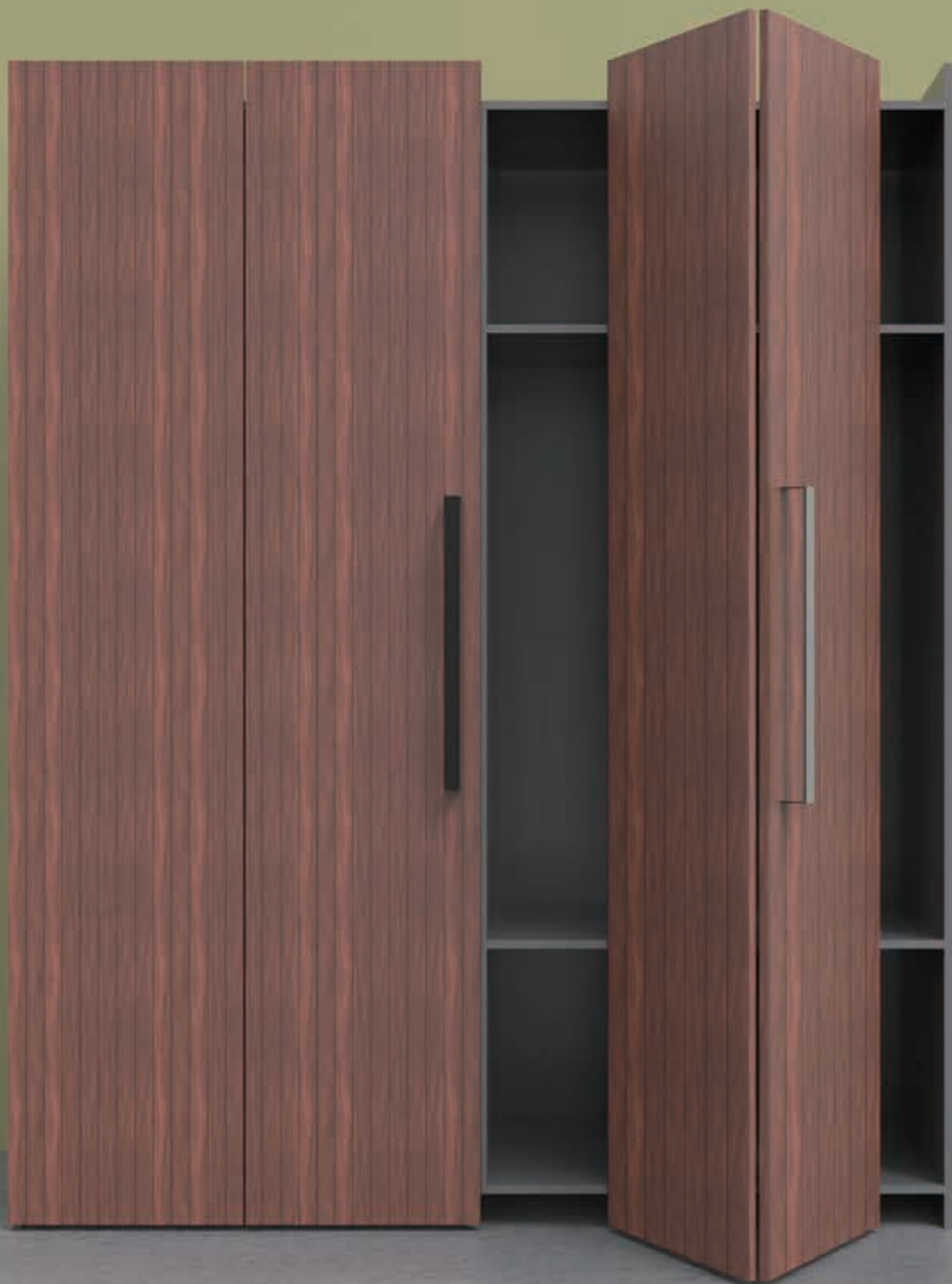

SW sliding system

Folding sliding system - SWF002



- Folding door
- Soft-close system
- 20KG/door loading capacity
- Damper with anti jumping and anti-decoupling
- 300-600mm door width
- Min. 16mm door thickness
- Wooden door and aluminum frame door



	Item	Quantity (2 doors)
	Left upper runner	1 pc
	Left lower runner	1 pc
	Right upper runner	1 pc
	Right lower runners	1 pc
	Plastic hinge	4 pcs
	Damper	2 pcs
	Position template	1 pc
	Fixing accessories	1 pc
	8mm spanner	1 pc
	ST4*16 screw	46 pcs
Item No.		SWF002

	Item	Item No.	Remark
	Upper and lower rail	SWF02-R	3000mm length;

Space required

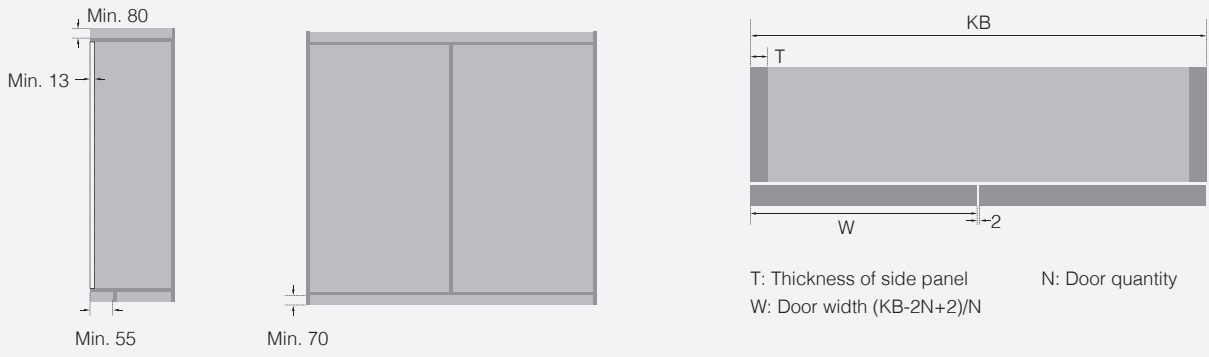

Space required

Without top cabinet

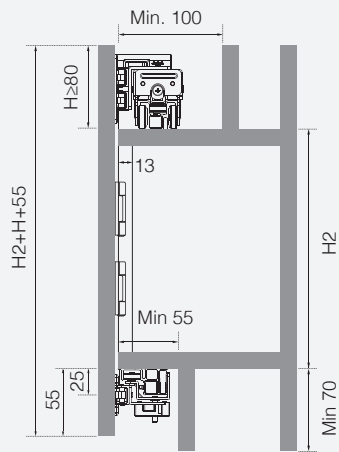

With top cabinet

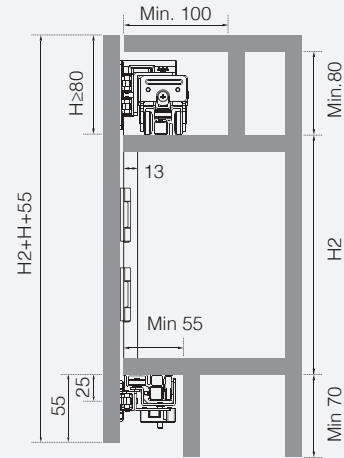

Installation rails and runners for four doors

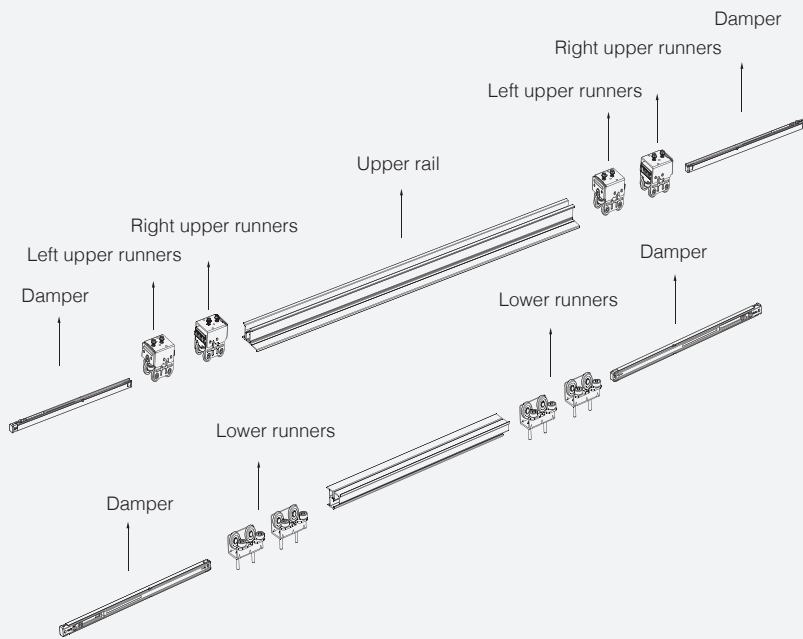

Installation dimension of doors (4 doors)

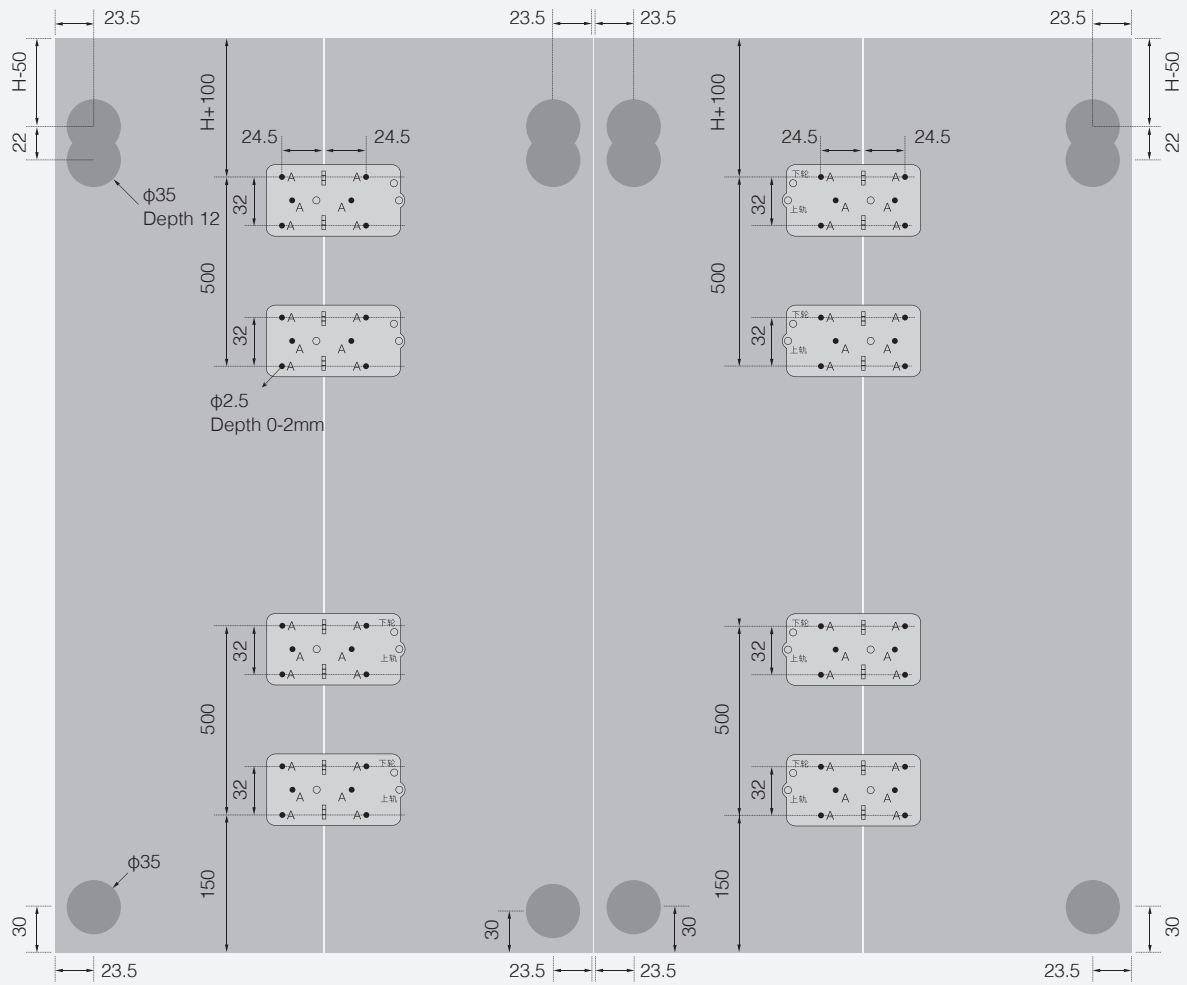

Folding sliding system

SWF003-1



SW sliding system

Folding sliding system - SWF003-1



- Folding door
- Soft-close system
- 15KG/door loading capacity
- Brush device for cleaning dust on the rail
- 300-500mm door width
- 18-25mm door thickness
- Max door height 1200mm



	Item	Quantity (2 doors)
	Upper runner	1 pc
	Folding hinge	1 pc
	Stopper	1 pc
	Overlay hinge	2 pcs
	Plastic hinge	1 pc
	Position template	1 pc
	ST4x16 wooden screw	30 pcs
Item No.		SWF003-1

	Item	Item No.	Remark
	Upper rail	SWF03-UR	3000mm length;

Space required

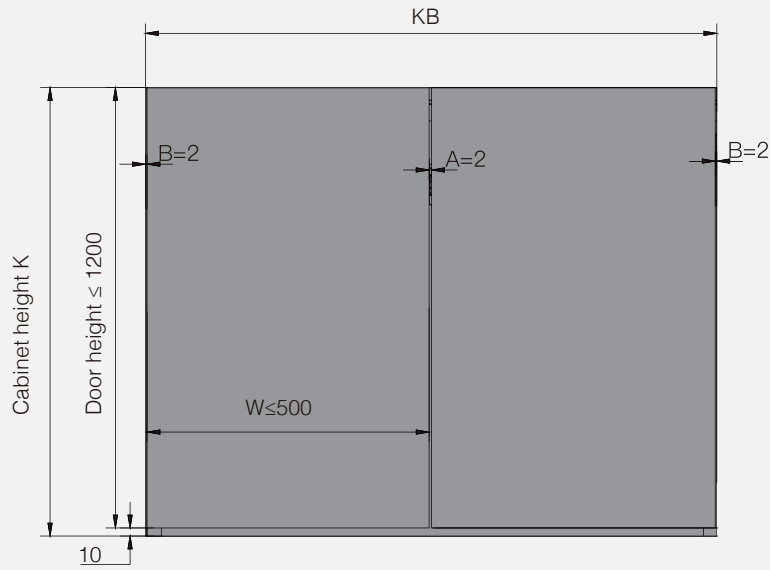

A: 2mm gap for plastic hinge installation
 B: 2mm gap for door overlay
 Door width: $W = \frac{KB-6}{2} \leq 500\text{mm}$
 Door height: $H = K-10 \leq 1200\text{mm}$

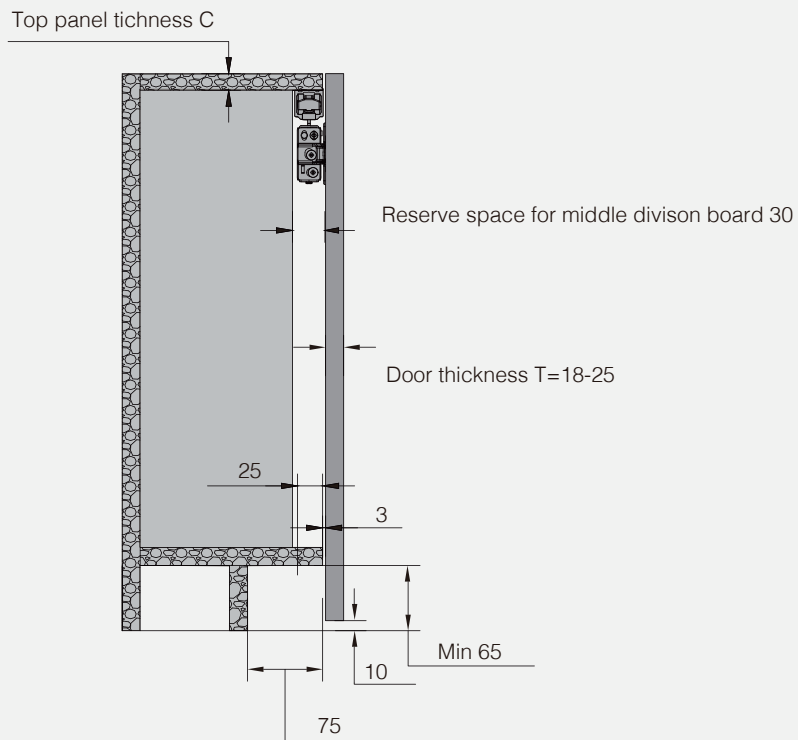

Dimension for drilling holes

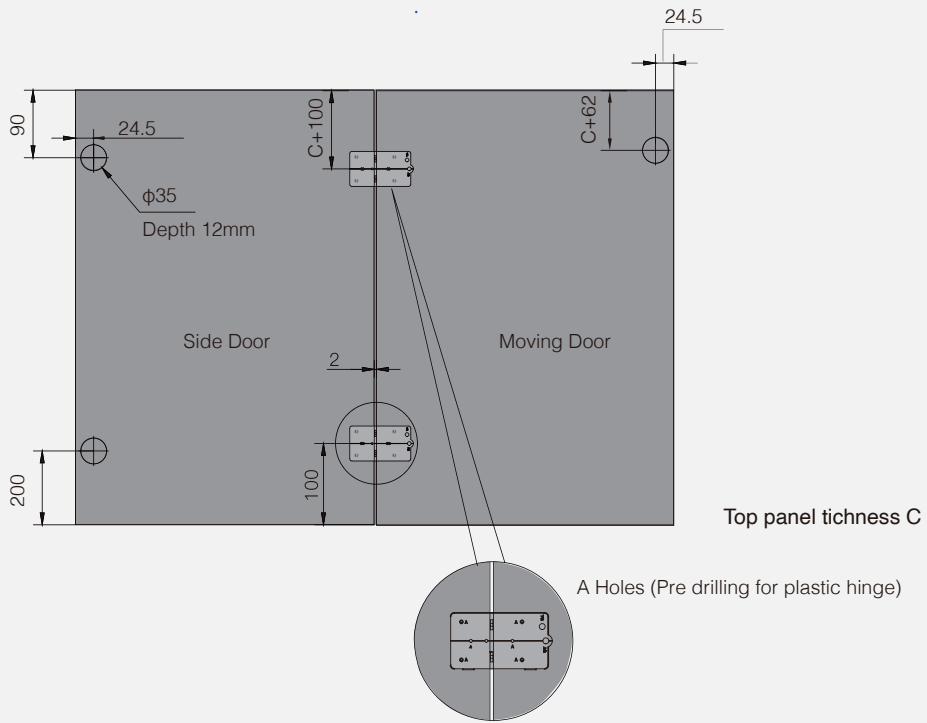

Application and installation

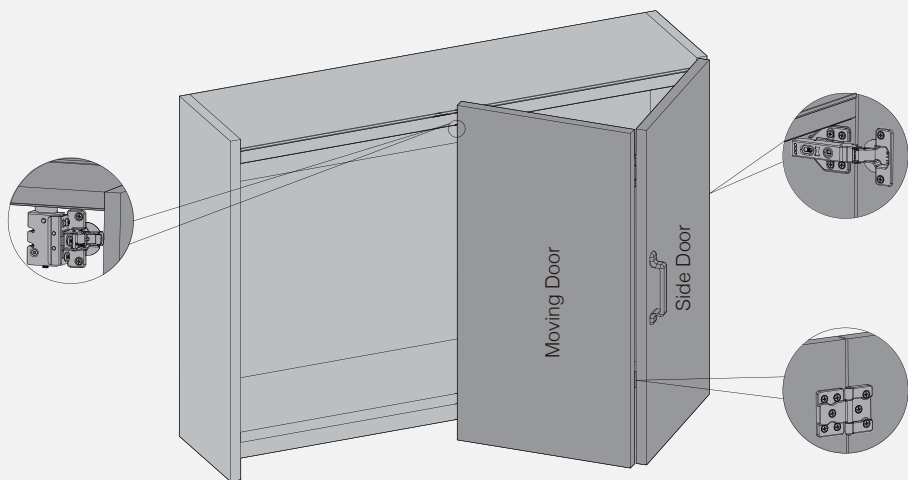
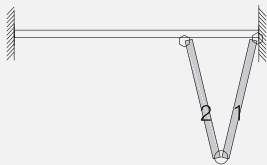

Folding sliding system

SWF003-2



SW sliding system

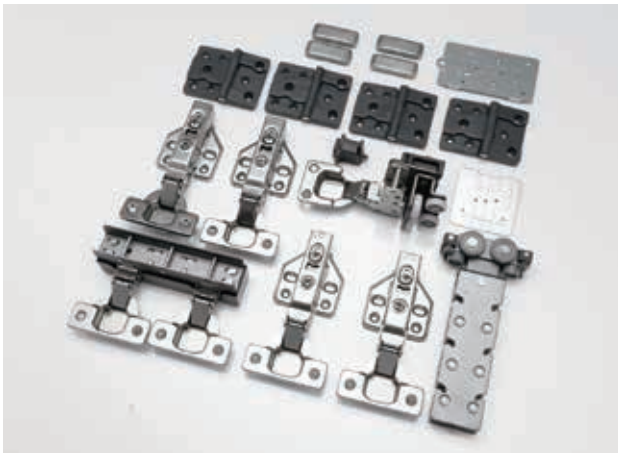

Folding sliding system - SWF003-2



- Folding door
- Soft-close system
- 25KG/door loading capacity
- Brush device for cleaning dust on the rail
- 300-500mm door width
- 18-25mm door thickness
- Max door height 2400mm



	Item	Quantity (2 doors)
	Upper runner	1 pc
	Folding upper hinge	1 pc
	Folding lower hinge	1 pc
	Stopper	1 pc
	Overlay hinge	4 pcs
	Plastic hinge	4 pcs
	Position template	1 pc
	ST4x16 wooden screw	62 pcs
Item No.		SWF003-2

	Item	Item No.	Remark
	Upper rail	SWF03-UR	3000mm length;
	Lower rail	SWF03-LR	3000mm length;

Space required

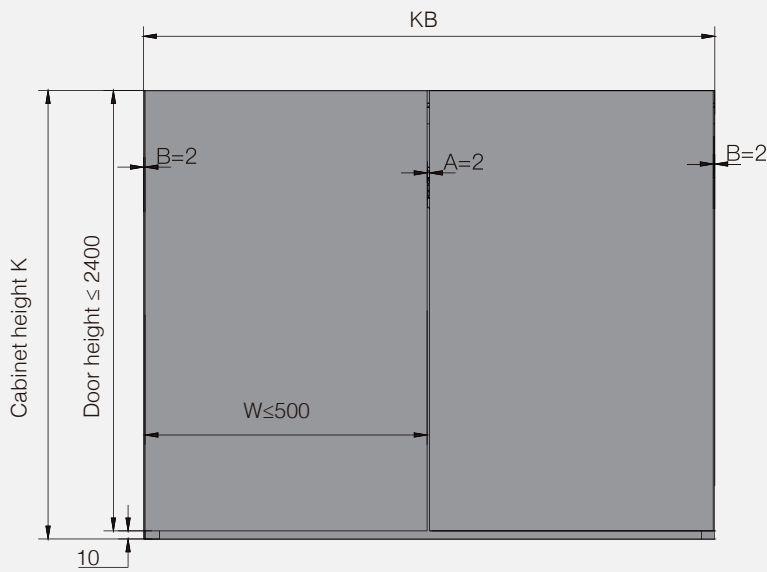

A: 2mm gap for plastic hinge installation
 B: 2mm gap for door overlay
 Door width: $W = \frac{KB-6}{2} \leq 500\text{mm}$
 Door height : $H = K - 10 \leq 2400\text{mm}$

Top panel tichness C

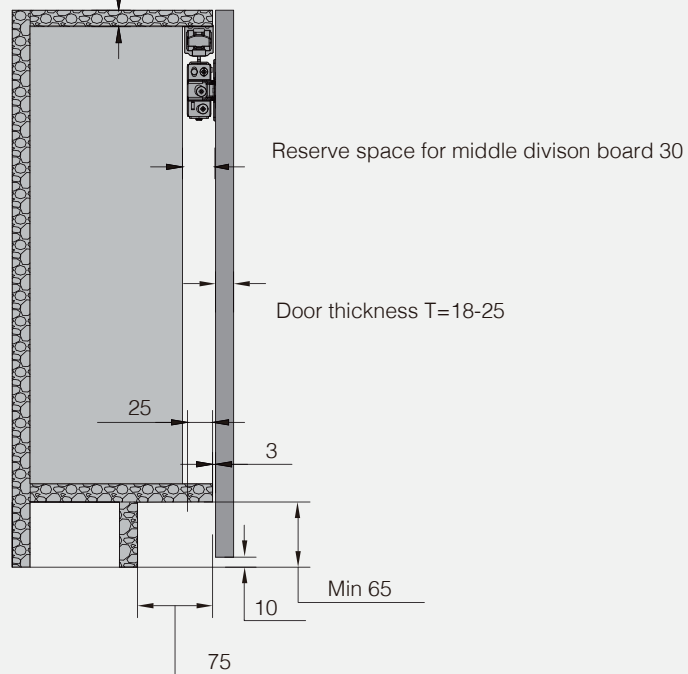

Dimension for drilling holes

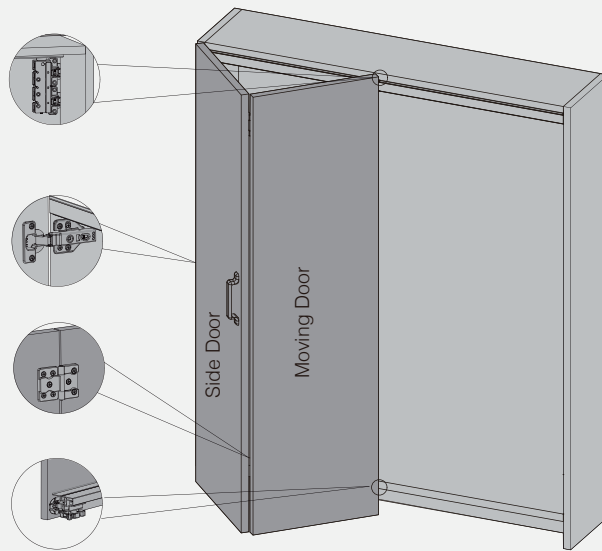
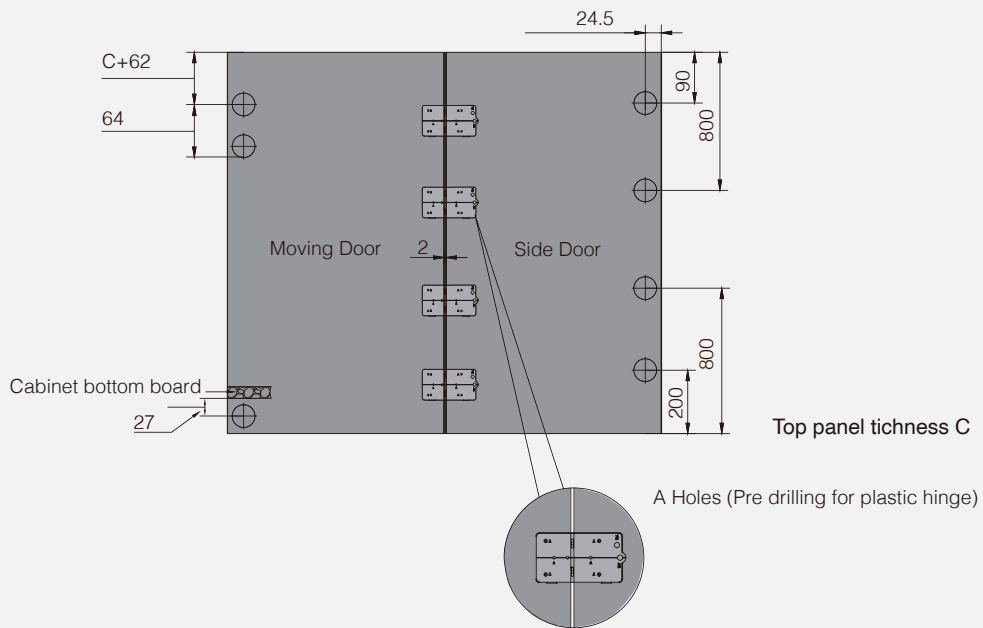

Adjusting folding lower hinge from right open to left open

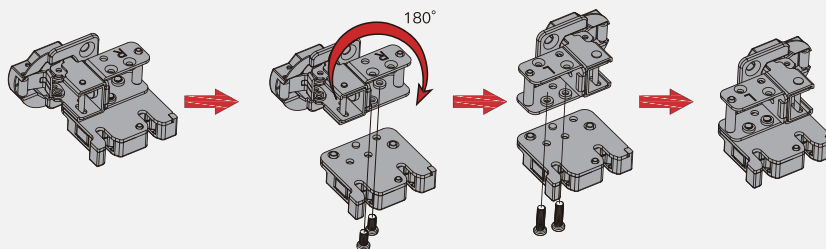

For more information, please visit CEMUX.COM
or contact us email CEMUX@CEMUX.CO.UK

CEMUX
LIVE YOUR LIFE

CEMUX TECHNOLOGY LTD

Kilkeary,
Nenagh,
Co. Tipperary
Ireland
Tel: 00353 67 31471